

### Códigos

1	FT9915	8	FT0066	15	FT4849
2	FT3756	9	FT2707	16	FT1734
3	FT1746	10	FT2690	17	FT9287 - 9365
4	FT1748	11	FT9462	18	FT1724
5	FT9808	12	FT1737	19	FT2527
6	FT1864	13	FT5580	20	FT1779
7	FT1747	14	FT1736		

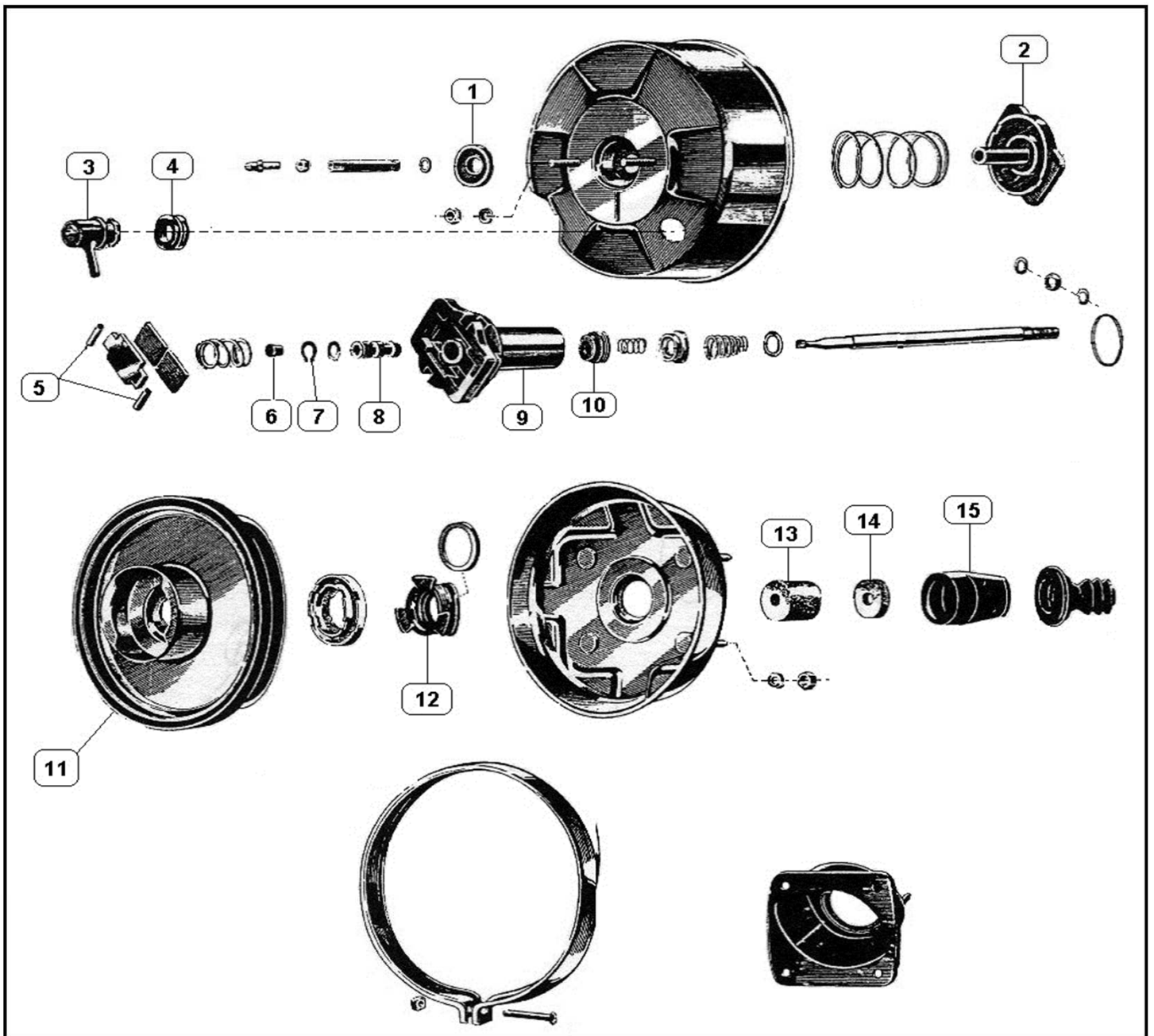

## Códigos

1	FT7438
2	FT6511
3	FT9629
4	FT1864
5	FT6604

6	FT6603
7	FT6582
8	FT6581
9	FT6643
10	FT7437

11	FT7332
12	FT6579
13	FT6641
14	FT6640
15	FT6580

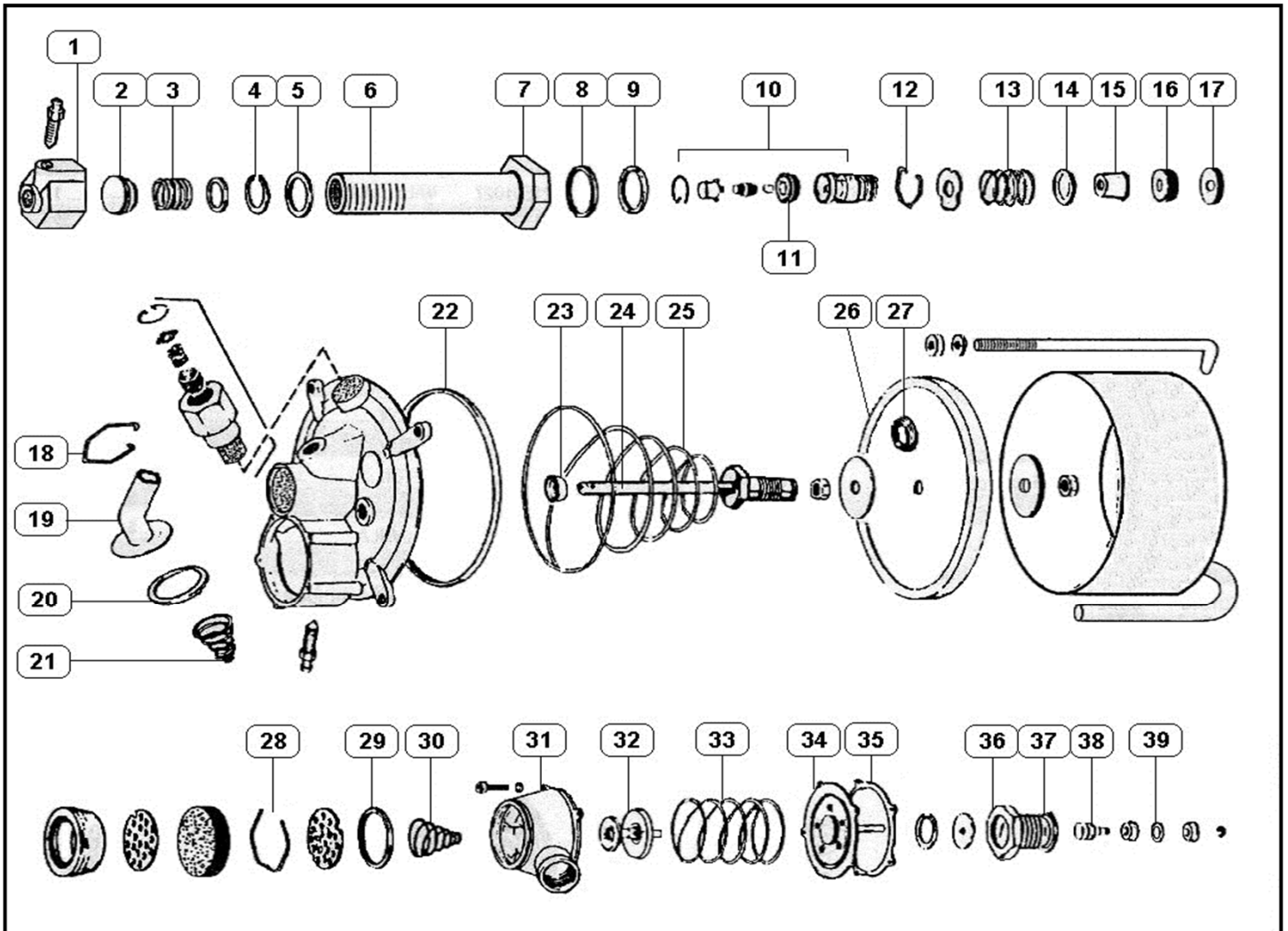

## Códigos

1	FB2059	9	FB2247	17	FB2021	25	FB2105	33	FB2107
2	FB2050	10	FB2066	18	FB2045	26	FB2316	34	FB2090
3	FB2058	11	FB2071	19	FB2038	27	FB2082	35	FB2106
4	FB2056	12	FB2020	20	FB2044	28	FB2045	36	FB2007
5	FB2064	13	FB2023	21	FB2046	29	FB2044	37	FB2006
6	FB2062	14	FB2018	22	FB2108	30	FB2046	38	FB2003
7	FB2063	15	FB2017	23	FB2011	31	FB3580	39	FB2004
8	FB2223	16	FB2016	24	FB2078	32	FB6934		

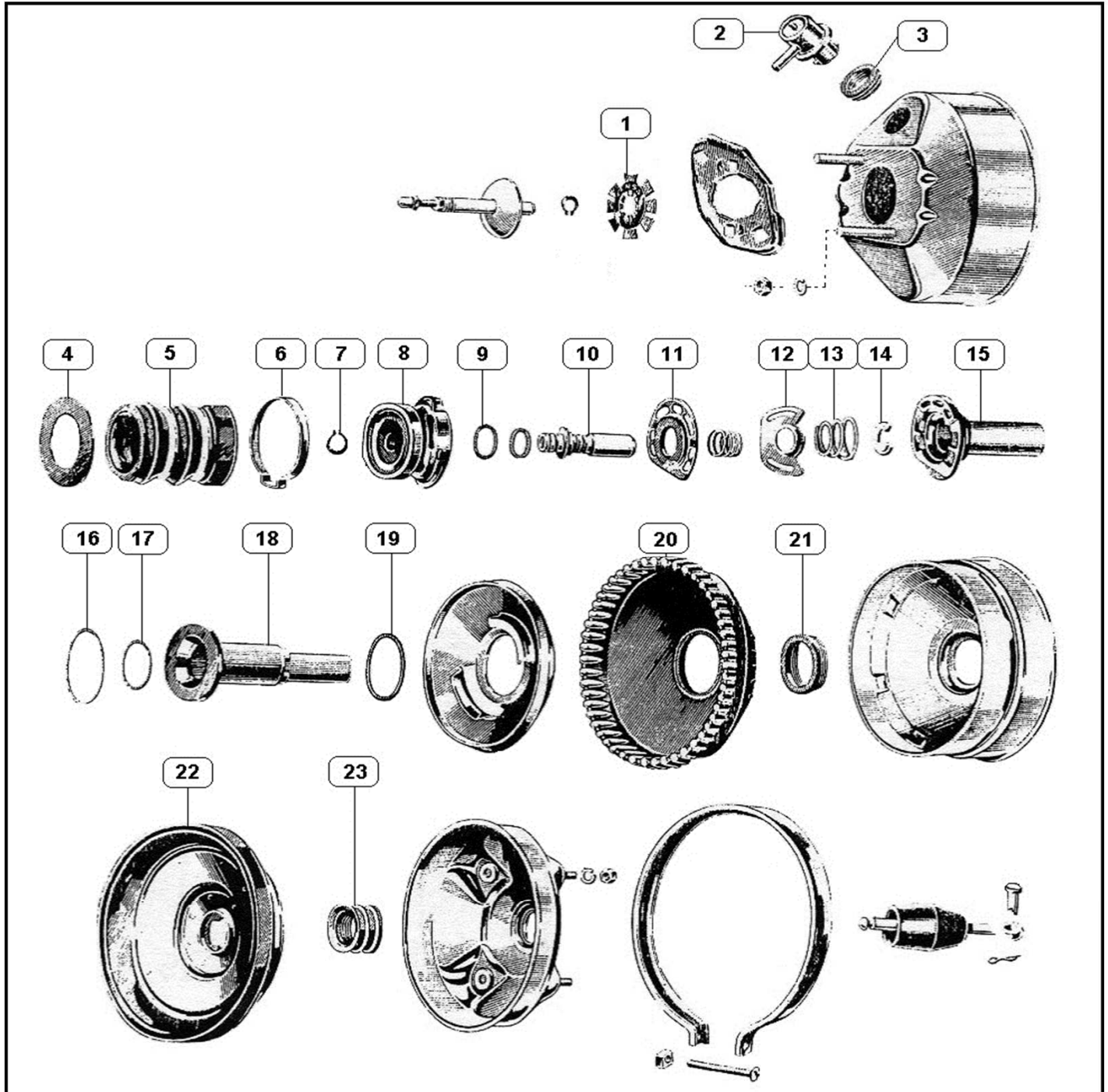

## Códigos

1	FT9915	7	FT0066	13	FT5580	19	FT2065
2	FT9629	8	FT2707	14	FT1736	20	FT2062
3	FT1864	9	FT1743	15	FT4849	21	FT2070
4	FT1746	10	FT2690	16	FT1734	22	FT9295
5	FT1748	11	FT9462	17	FT2064	23	FT2066
6	FT1747	12	FT1737	18	FT2068		



# DIAFRAMAS PARA SERVO BENDIX

# F

Código	Descripción	Material	Diam. Ext.	Aguj. Int.	Altura
FB0946	DIAF. CHEVROLET C30 - FORD F350 - TOYOTA CAMION-PICK-UP	Solo goma	218mm	63mm	27mm
FB2141	DIAF. LABIO FINO MECANICO FIAT 1500/125 - CHEVROLET 400	Solo goma	170mm	62mm	30mm
FB2316	DIAF. SERVO BENDIX SUPER HIDROVAC TIPO FF67 FORD F600 / 700 AGUJ. CHICO	Goma-Chapa	9 1/2"	14mm	20mm
FB2316/1	DIAF. SERVO SUPER TACHO HIDROVAC TIPO FF67 FORD F600 / 700 REFORMA AGUJ. GDE.	Goma-Chapa	239mm	-	20mm
FB2319	DIAF. SUPER CHICO HIDROVAC TIPO FF46 FORD F100 65/72 - FALCON - F350	Goma-Chapa	6 3/4"	8mm	14,5mm
FB2319/1	DIAF. HYDROVAC SUPER CHICO (AGUJ. GDE.) TIPO FF46 FORD F100 65/72 - FALCON - F350	Goma-Chapa	6 3/4"	14,5mm	14,5mm
FB2352	DIAF. D/TANDEM BENDIX FALCON - TORINO - GROSSPAL	Solo goma	186mm	116mm	27mm
FB2354	DIAF. D/TANDEM BENDIX FALCON - TORINO - GROSSPAL	Solo goma	175mm	65mm	36mm
FB2493	DIAF. MECANICO MASTERVAC FORD F100 - FIAT 128	Solo goma	175mm	62mm	30mm
FB2617	DIAF. MASTERVAC P504 2000cc - FORD F100	Solo goma	8"	63mm	-
FB2659	DIAF. MASTERVAC	Solo goma	6"	63mm	35mm
FB2696	DIAF. MASTERVAC BENDIX FORD F100/150 - R18 - P505 - CHEVROLET C10	Solo goma	9"	62mm	53mm
FB2827	DIAF. BENDIX-BOSCH TEMPRA - TIPO - FIORINO - UNO - SIERRA - ESCORT - P405 - EXPRESS - R19 - MEGANE - CLIO - HILUX 2003 - CADDY - GOL	Solo goma	8 1/2"	64mm	30mm
FB2901	DIAF. MASTERVAC P505 - F100/350	Solo goma	9"	62mm	53mm



FB0946



FB2141



FB2316

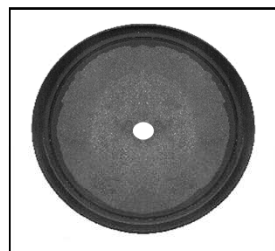

FB2316/1

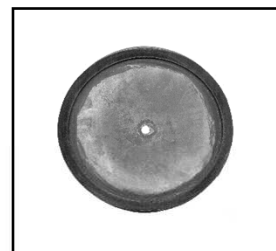

FB2319



FB2319/1



FB2352



FB2354



FB2493



FB2617



FB2659



FB2696



FB2827



FB2901



# DIAFRAMAS PARA SERVO TENSA

# F

Código	Descripción	Material	Diam. Ext.	Aguj. Int.	Altura
FT1101	DIAF. SERVO DESCARTABLE GIRVAC R9/11/12 - SIERRA - ESCORT - FIESTA - LADA - GACEL	Solo goma	222mm	54mm	
FT1114	DIAF. RENAULT TRAFIC 1400	Solo goma	235mm	50mm	
FT2062	DIAF. CORRUGADO SIST. TANDEM TIPO C-4260 CHEVY - FALCON - RAMBLER - TORINO - P504	Solo goma	180mm	51mm	
FT7332	DIAF. MARK IV F100/150 - TAUNUS - R18 - P505	Goma-Chapa	7 7/8"	52,8mm	41mm
FT7740	DIAF. ALTO VARGA KOMBI - GACEL - SAVEIRO	Goma-Chapa	7 7/8"	52,8mm	41mm
FT7740B	DIAF. BAJO VARGA KOMBI - GACEL - SAVEIRO	Goma-Chapa	7 7/8"	52,8mm	35mm
FT7740G	DIAF. VARGA GALAXY - GOLF - CARAT - GACEL	Goma-Chapa	8 1/2"	52,8mm	35mm
FT7818	DIAF. MARK IV RENAULT TRAFIC 2000cc	Goma-Chapa	10 5/8"	52,8mm	67mm
FT9006	DIAF. SERVO HIDRAULICO BAJO MOD. C-20169-A FALCON - P403/404 - DAUPHINE/GORDINI	Goma-Chapa	166mm	8mm	30mm
FT9011	DIAF. SERVO HIDRAULICO ALTO FIAT 600/750/770 - RAMBLER - R4L/DAUPHINE/GORDINI - JEEP IKA	Goma-Chapa	165mm	8mm	38mm
FT9017	DIAF. SERVO HIDRAUL. MEDIANO C-20169 RAMBLER AMBASSADOR - CROSS COUNTRY - TORINO 300	Goma-Chapa	198mm	9mm	52mm
FT9021	DIAF. SERVO HIDRAULICO GRANDE TORINO 380 - RAMBLER - GLADIATOR	Goma-Chapa	234mm	8mm	34mm
FT9206	DIAF. MECANICO GRANDE MODELO C-4200 FORD F100/250/350 - TAUNUS - P504 - DODGE	Goma-Chapa	9 7/32"	-	
FT9287	DIAF. SERVO MECANICO TANDEM C-3200 - FIAT - PEUGEOT '70s - DODGE 1500 - FALCON	Goma-Chapa	7 3/4"	-	
FT9295	DIAF. SERVO TANDEM TIPO C-4260 CHEVY - FALCON - RAMBLER - TORINO - P504	Goma-Chapa	7 1/2"	-	56mm
FT9365	DIAF. MECANICO ALTO SIST. TANDEM C-3200 FIAT - PEUGEOT - FALCON - R12 - TAUNUS - OPEL K180 - CHEV. PICK-UP	Goma-Chapa	7 3/4"	-	31mm

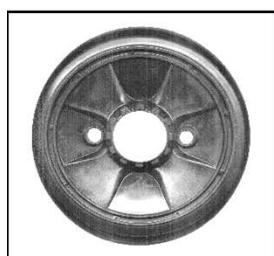

FT1101

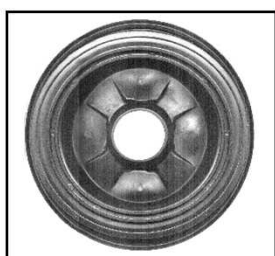

FT1114

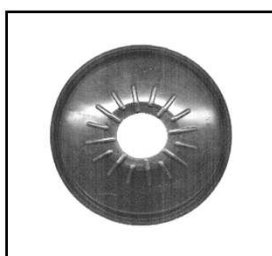

FT2062

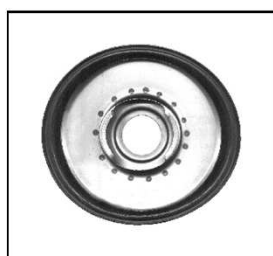

FT7332



FT7740



FT7740B



FT7740G



FT7818



FT9006

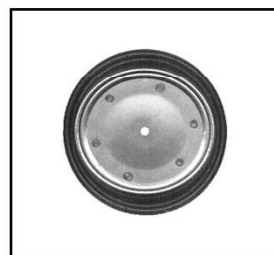

FT9011



BUSCAR



# DIAFRAMAS PARA SERVO TENSA

F



FT9017



FT9021



FT9206



FT9287



FT9295



FT9365

## DIAFRAGMAS PARA SERVO MIDLAND

Código	Descripción	Material	Diam. Ext.	Aguj. Int.	Altura
FM9398	DIAF. 11 3/8"	Goma-Chapa	243mm	9mm	51mm
FM1502555	DIAF. 11"	Goma-Chapa	280mm	9,5mm	65mm
FM59T2394A	DIAF. 9 3/4" (3 GRAMPAS)	Goma-Chapa	247mm	11mm	42mm
FMB3T2394A	DIAF. MOD. D-20176 FORD 600/500 MODELO '57	Goma-Chapa	243mm	9mm	51mm
FMB7T2394A	DIAF. MOD. C-20176-B FORD 500/600 58/78	Goma-Chapa	246mm	9mm	59mm



FM9398



FM1502555



FM59T2394A



FMB3T2394A



FMB7T2394A

## DIAFRAGMAS PARA SERVO SYLVANIA

Código	Descripción	Material	Diam. Ext.	Aguj. Int.	Altura
FS10031	SYLVANIA	Solo goma	170mm	14mm	28mm
FS10032	SYLVANIA	Solo goma	196mm	14mm	35mm
FS10035	SYLVANIA	Solo goma	212mm	14mm	21mm
FS10050	SYLVANIA	Solo goma	166mm	14mm	20mm

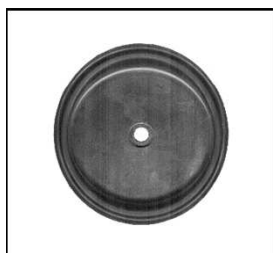

FS10031

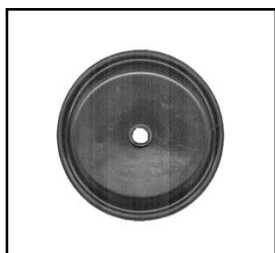

FS10032



FS10035

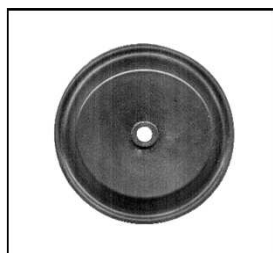

FS10050





## GRASA DE ARMADO

Código	Descripción
FGR0030	GRASA ROJA POTE DE 30 GRS.
FGR0060	GRASA ROJA POTE DE 60 GRS.
FGR0100	GRASA ROJA POTE DE 100 GRS.
FGR0250	GRASA ROJA POTE DE 250 GRS.
FGR1000	GRASA ROJA POTE DE 1 KILO
FGS0030	GRASA SILICONADA POTE DE 30 GRS.
FGS0060	GRASA SILICONADA POTE DE 60 GRS.
FGS0100	GRASA SILICONADA POTE DE 100 GRS.
FGS0250	GRASA SILICONADA POTE DE 250 GRS.
FGS1000	GRASA SILICONADA POTE DE 1 KILO
FGV0030	GRASA VASELINADA POTE DE 30 GRS.
FGV0060	GRASA VASELINADA POTE DE 60 GRS.
FGV0100	GRASA VASELINADA POTE DE 100 GRS.
FGV0250	GRASA VASELINADA POTE DE 250 GRS.
FGV1000	GRASA VASELINADA POTE DE 1 KILO



## LIQUIDO VASELINADO

Código	Descripción
FLV100	LIQUIDO VASELINADO DE ARMADO x 100cc







## DIAFRAGMAS TIPO BENDIX-USA

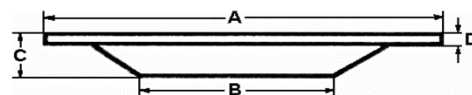

CODIGO BUCO	DIAMETRO NOMINAL "A"	CAMARA TIPO	CODIGO BENDIX	DIAFRAGMA EQUIVALENTE	DIAM. "B"	ALTURA "C"	LABIO "D"
F234433	126mm - 5"	9"	234433	9" PROF.	73mm	35mm	8,5mm
F234226	137mm 5 1/2"	12"	234226	12" PROF.	80mm	30mm	8,5mm
F234189	155,5mm - 6"	16"	234189	---	101,6mm	32,5mm	8,5mm
F234099	167mm - 6 3/4"	20"	234099	VARGA 0047,5	106mm	32mm	8,5mm
F234100	180mm - 7"	24"	234100	VARGA 6449,8	113,5mm	37mm	8,5mm
F234101	198mm - 8"	30"	234101	VARGA 6933,1	132mm	40mm	8,5mm
F234101N	202mm - 8"	30"	---	---	132mm	40mm	8,5mm
F234362	220mm - 9"	36"	234362	---	142mm	45mm	8,5mm

## DIAFRAGMAS TIPO WABCO

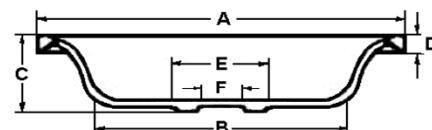

CODIGO BUCO	DIAMETRO NOMINAL "A"	CAMARA TIPO	CODIGO WABCO	DIAMETRO "B"	ALTURA "C"	LABIO "D"	RESALTOS
							E
F36019	139mm - 5 1/2"	12"	897120505,4	85mm	39mm	8,5mm	44mm
F36031	148mm - 5 13/16"	14"	897121610,4	86mm	38mm	9,5mm	42mm
F36032	149mm 5 7/8"	14"	897121615,4	90mm	36mm	8,5mm	41mm
F36024	159mm - 6 1/4"	16"	897120510,4	100mm	38mm	8,5mm	40mm
F36023	159mm - 6 1/4"	16"	897120516,4	100mm	51mm	8,5mm	42mm
F36030	165mm - 6 1/2"	20"	897120520,4	105mm	45,5mm	8,5mm	---
F36022	200mm - 7 15/16"	27"	897121922,4	117mm	37mm	8,5mm	---
F36038	175mm - 6 7/8"	24"	897120535,4	110,5mm	46mm	8,5mm	43mm
F36033	168mm - 6 5/8"	20"	897120526,4	115mm	46mm	8,5mm	43mm
F36034	179mm - 7 1/6"	24"	897120536,4	115mm	44mm	8,5mm	42mm
F36035	201mm - 7 15/16"	30"	897120546,4	131,4mm	49mm	8,5mm	42mm

## DIAFRAGMAS TIPO KNORR

CODIGO BUCO	DIAMETRO NOMINAL "A"	CAMARA TIPO	CODIGO KNORR	DIAMETRO "B"	ALTURA "C"	LABIO "D"	RESALTOS
							E
F36020	140mm - 5 1/2"	12"	2B56620	82mm	35mm	9,5mm	38mm
F36029	148mm - 5 13/16"	14"	2B54871	82mm	49mm	8,5mm	40mm
F36039	156,4mm - 6 1/8"	16"	3B49363/2	98mm	40mm	8,5mm	40mm
F36040	168mm - 6 5/8"	20"	3B42465/5	110mm	35mm	8,5mm	43mm



## DIAFRAGMAS TIPO FREUDEMBERG

CODIGO BUCO	DIAMETRO NOMINAL "A"	CAMARA TIPO	CODIGO FREUDEMBERG	DIAMETRO "B"	ALTURA "C"	LABIO "D"	RESALTOS
							E
F36033	168mm - 6 5/8"	20"	3RM-4679/2	115mm	46mm	8,5mm	43mm
F36034	179mm - 7 1/16"	24"	3RM-4679/3	115mm	44mm	8,5mm	42mm
F36035	201mm - 7 15/16"	30"	3RM-4679/4	131,4mm	49mm	8,5mm	42mm

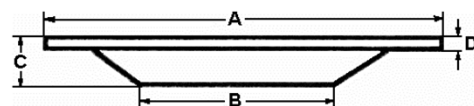

## DIAFRAGMAS TIPO MIDLAND TENSA

CODIGO BUCO	DIAMETRO NOMINAL "A"	CAMARA TIPO	CODIGO MIDLAND	DIAFRAGMA EQUIVALENTE	DIAM. "B"	ALTURA "C"	LABIO "D"
F11501486	181mm - 7"	24"	N20097	VPDF0016,7	116mm	35mm	8mm
F11503409	203mm - 8"	30"	N20130	VPDF0014,0	140mm	35mm	10mm

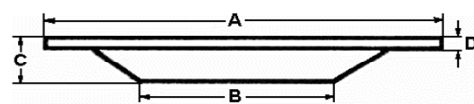

## DIAFRAGMAS VARIOS

CODIGO BUCO	DIAMETRO NOMINAL "A"	CAMARA TIPO	DIAFRAGMA EQUIVALENTE	DIAM. "B"	ALTURA "C"	LABIO "D"
F36005	126mm - 5"	9" BAJO	234433 VIEJO	70mm	28mm	8mm
F36000	139mm 5 1/2"	12"	234226 VIEJO	88mm	24mm	8mm
F36008	165mm - 6 1/2"	20"	234099 VIEJO	102mm	33mm	6,5mm
F36013	177mm - 7"	24"	INTER-FRENOS	112mm	29mm	13mm
F36002	178mm - 7"	24"	WL-17546	113mm	31mm	7,5mm
F36002A	178mm - 7"	24"	FREPILCO	110mm	32mm	9mm
F36001	202mm - 8"	30"	234101 VIEJO	133mm	39m	8,5mm
F36001A	202mm - 8"	30"	234101/1	140mm	44mm	10mm
F36001B	202mm - 8"	30"	234101/5	140mm	46mm	11mm
F36012	202mm - 8"	30"	ASTIVIA	124mm	42mm	11mm
F36006	203mm - 8"	30"	WL-100032	135mm	35mm	12mm
F36014	203mm - 8"	30"	EL DETALLE-RANDON	132mm	38mm	11mm
F36021(a)	200mm - 8"	30"	HELVETICA	138mm	39mm	10mm
F36007(a)	205mm - 8"	30"	HEVETICA-M70	112mm	40mm	10mm
F36016	223mm - 9"	36"	MILEI	132mm	38mm	9,5mm
F36011	224mm - 9"	36"	SYLVANIA	130mm	44mm	13mm
F36010	225mm - 9"	36"	N20136	145mm	43mm	10mm
F36009	225mm - 9"	36"	FREPILCO	154mm	36mm	12mm
F36003	228mm - 9"	36"	234362 VIEJO	148mm	37mm	10mm
F36003A	228mm - 9"	36"	INTER-FRENOS	148mm	30mm	10,5mm
F36015	228mm - 9"	36"	FREPILCO	145mm	36mm	10,5mm
F378767			CONJ. DIAF. SERVO HIDRAULICO			



# DESPIECE Y REPARACIONES SERVO BENDIX

**F**

Código	Descripción	Código	Descripción
FB0049	REMACHE SERVO	FB2139	TRABA DE BAKELITA B 2615 - B 2140
FB0050	REMACHE DE VASTAGO	FB2140	CUERPO DE VALVULA PLATO MECANICO
FB0215	RETEN RENAULT 9-11 (INDUVAR)	FB2146/1	RETEN MASTERVAC (ORIGINAL)
FB0216	RETEN FIAT DUNA ATE	FB2146/2	RETEN MASTERVAC (CON BAQUELITA)
FB1100	SELLO P/VALVULA ESCORT / GACEL	FB2147	SELLO RETEN BX-BOSCH GOMA Y CHAPA
FB1203	RETEN TRASERO BENDIX-BOSCH	FB2150	VALVULA DE RETENCION (PICO FINO)
FB2003	PISTON VALVULA 1/2" SERVO SUPER	FB2150/1	VALVULA DE RETENCION (PICO GRUESO)
FB2004	CUBETA PARA PISTON 2003	FB2157	CHAPA PARA ASIENTO B 2159
FB2006	JUNTA DE CILINDRO ROSCADO	FB2157D	ASIENTO MASTER FIAT DUNA
FB2007	CILINDRO ROSCADO SERVO SUPER	FB2158	ASIENTO COMPLETO
FB2011	RETEN DE GRASA	FB2159	SELLO RETEN SERVO MASTERVAC
FB2016	CUBETA CIERRE HIDRAULICO	FB2160	SELLO PARA VALVULA DE RETENCION
FB2017	BUJE SOMBRERO PARA CIERRE	FB2160/1	SELLO P/VALV. RETENC. (AGUJ. CHICO)
FB2018	ARANDELA DE EMPUJE	FB2160/2	SELLO P/VALV. RETENC. (AGUJ. GRANDE)
FB2020	ANILLO RETEN SERVO SUPER	FB2163	DISCO REACCION MASTERVAC
FB2021	ARANDELA GUIA DE EMPUJE	FB2163/1	DISCO REACCION MASTERVAC
FB2023	RESORTE	FB2164	GUARDAPOLVO SERVO MASTERVAC
FB2038	TUBO DE VACIO SERVO SUPER	FB2203	PISTON VALVULA HIDR. SERVO 6 3/4"
FB2044	JUNTA DE GOMA	FB2204	CUBETA PARA PISTON B 2203
FB2045	RETEN	FB2208	CILINDRO ROSCADO SERVO 6 3/4"
FB2046	RESORTE CONICO	FB2220	JUNTA ALUMINIO
FB2050	VALVULA DE RETENCION 1" SUPER	FB2221	CILINDRO ROSCADO 1"
FB2056	RETEN	FB2223	JUNTA DE TUERCA
FB2058	RESORTE HIDROVAC CONICO	FB2224	PISTON PARA CILINDRO B 2221
FB2059	CABEZAL SERVO SUPER	FB2229	CONJUNTO DE EMPUJE
FB2061	JUNTA PARA TUERCA	FB2238	DIAFR. SUPER CHICO PICO CORTO
FB2062	TUBO CILINDRO HIDRAULICO	FB2244	TENSOR SERVO SUPER
FB2063	TUERCA PARA TUBO HIDRAULICO	FB2244/1	TENSOR SERVO MEDIANO
FB2064	ARANDELA JUNTA	FB2246	JUNTA DE SERVO CHICO
FB2066	PISTON HIDRAULICO 13/16"	FB2247	JUNTA DE CILINDRO HIDRAULICO
FB2071	CUBETA DE PISTON 13/16"	FB2309	CILINDRO ROSCADO 3/4"
FB2078	CONJUNTO VARILLA EMPUJE	FB2310	PISTON PARA CILINDRO B 2309
FB2078/1	EMPUJE MEDIANO	FB2313	CUBETA PARA PISTON B 2310
FB2083	TUERCA DE VASTAGO	FB2342	VALVULA DE CONTROL
FB2090	DIAFR. PICO LARGO SERVO SUPER	FB2350	SELLO RETEN FORD F350 DESCARTABLE
FB2104	AGARRE SERVO SUPER (ARO DE CIERRE)	FB2368	SELLO RETEN MASTERVAC FORD F350
FB2105	RESORTE PARA DIAFRAGMA SUPER	FB2372	SELLO PARA VALVULA 2488
FB2106	JUNTA P/DIAFR. B2090 SERVO SUPER	FB2488	VALVULA DE RETENCION (PICO FINO)
FB2107	RESORTE SERVO SUPER	FB2488/1	VALVULA DE RETENCION (ORIGINAL)
FB2108	JUNTA PARA TAPA SERVO SUPER	FB2615	CUERPO DE VALVULA (ORIGINAL)
FB2109	PASADOR P/PIST. 2066 - 2310 - 2224	FB2706	VALV. RETENC. (B2488 PICO GRUESO)
FB2110	JUNTA PARA CILINDRO HIDRÁULICO	FB2822	ASIENTO ISOVAC
FB2128	VALVULA DE CONTROL F1000	FB2822R	RETEN TRASERO COMPLETO
FB2128F	VALV. CONTROL SIERRA DESCARTABLE	FB2822/1	PLASTICO ISOVAC
FB2137	FILTRO DE SERVO	FB2825	CUERPO VALVULA RENAULT



# DESPIECE Y REPARACIONES SERVO BENDIX

# F

Código	Descripción	Código	Descripción
FB2838	TRABA P/CUERPO DE VALV. FB2615	FB7694	REPARACION MAYOR S. SUPER 1"
FB2936	VALVULA CONTROL ALTA	FB7705	REPARACION MENOR S. SUPER 1"
FB3572	CONJUNTO RETEN ASIENTO F1000	FB7706	REPARACION MENOR S. SUPER 3/4"
FB3580	CUERPO VALVULA ATMOSFERICA	FB7707	REPARACION MAYOR S. SUPER 3/4"
FB6934	VALVULA ATMOSFERICA SUPER	FB7708	REPARACION MENOR 3/4"
FB6939	RETEN FORD - DODGE - MIDLAND	FB8741	RETEN ORIGINAL MASTERVAC (3 PIEZAS)
FB7562	REPARACIÓN MAYOR SERVO SUPER	FB20488	RETEN TRAS. C3 - MEGANE TRW-VARGA-GIRLI
FB7563	REPARACION MENOR SERVO SUPER	FB251270	RETEN MEDIO D/T BOSCH MEGANE



FB0049



FB0050



FB0215



FB0216



FB1100



FB1203



FB2003

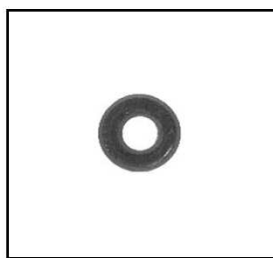

FB2004

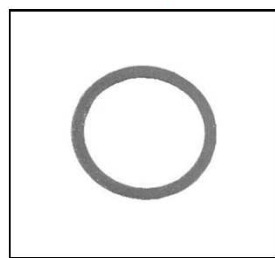

FB2006



FB2007



FB2011

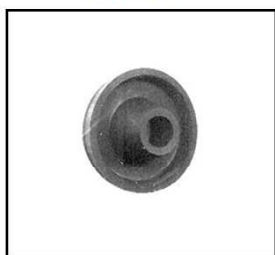

FB2016



FB2017



FB2018

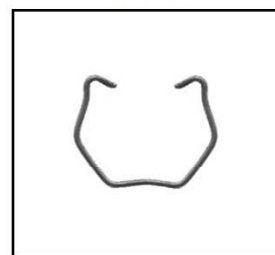

FB2020

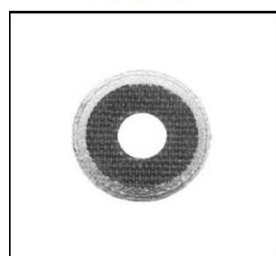

FB2021

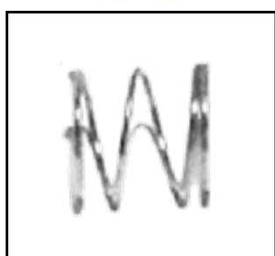

FB2023



FB2038

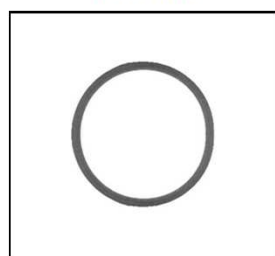

FB2044

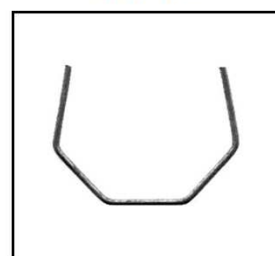

FB2045

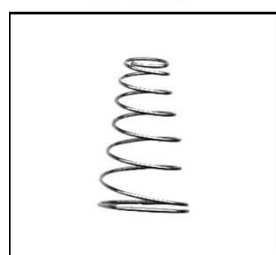

FB2046



FB2050



FB2056

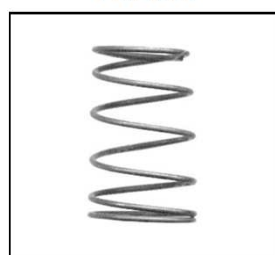

FB2058



FB2059



BUSCAR

# DESPIECE Y REPARACIONES SERVO BENDIX

# F

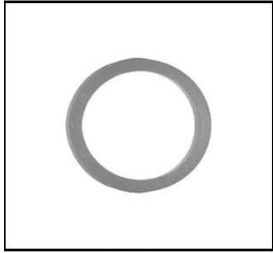

FB2061



FB2062



FB2063

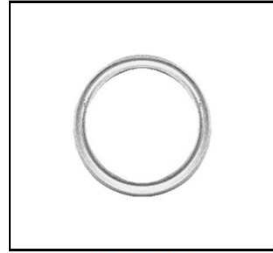

FB2064

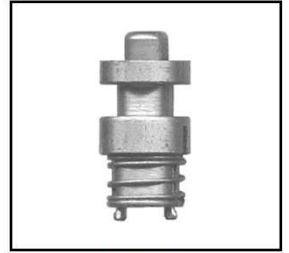

FB2066



FB2071



FB2078



FB2078/1



FB2083

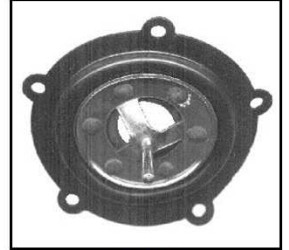

FB2090



FB2104

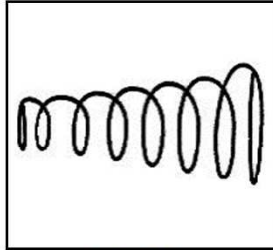

FB2105



FB2106

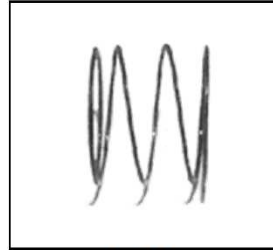

FB2107

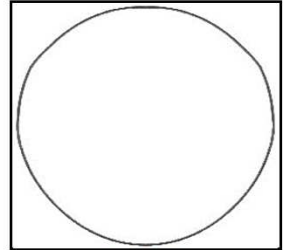

FB2108



FB2109

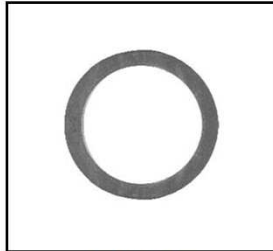

FB2110



FB2128



FB2128F

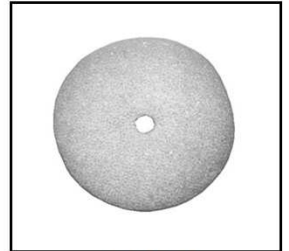

FB2137



FB2139

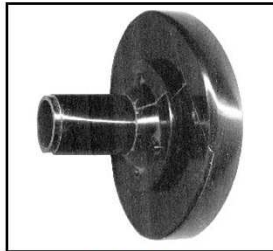

FB2140



FB2146/1



FB2146/2



FB2147



FB2150



FB2150/1



FB2157



FB2157D



FB2158



BUSCAR

# DESPIECE Y REPARACIONES SERVO BENDIX

# F

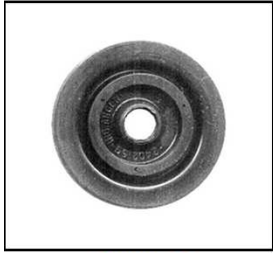

FB2159



FB2160



FB2160/1



FB2160/2

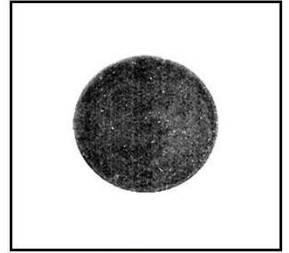

FB2163

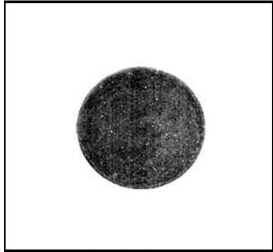

FB2163/1

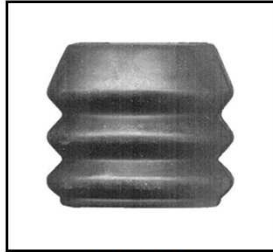

FB2164



FB2203



FB2204



FB2208



FB2220



FB2221



FB2223



FB2224



FB2229



FB2238



FB2244



FB2244/1

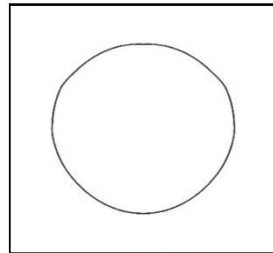

FB2246

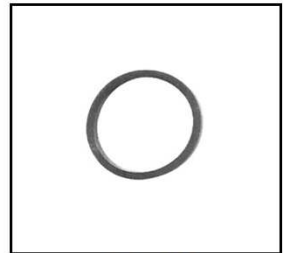

FB2247



FB2309



FB2310



FB2342



FB2350



FB2368

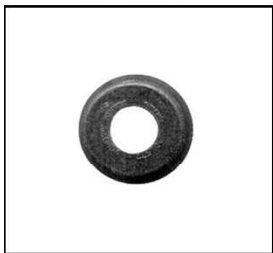

FB2372



FB2488



FB2488/1



FB2615



FB2706



# DESPIECE Y REPARACIONES SERVO BENDIX

# F

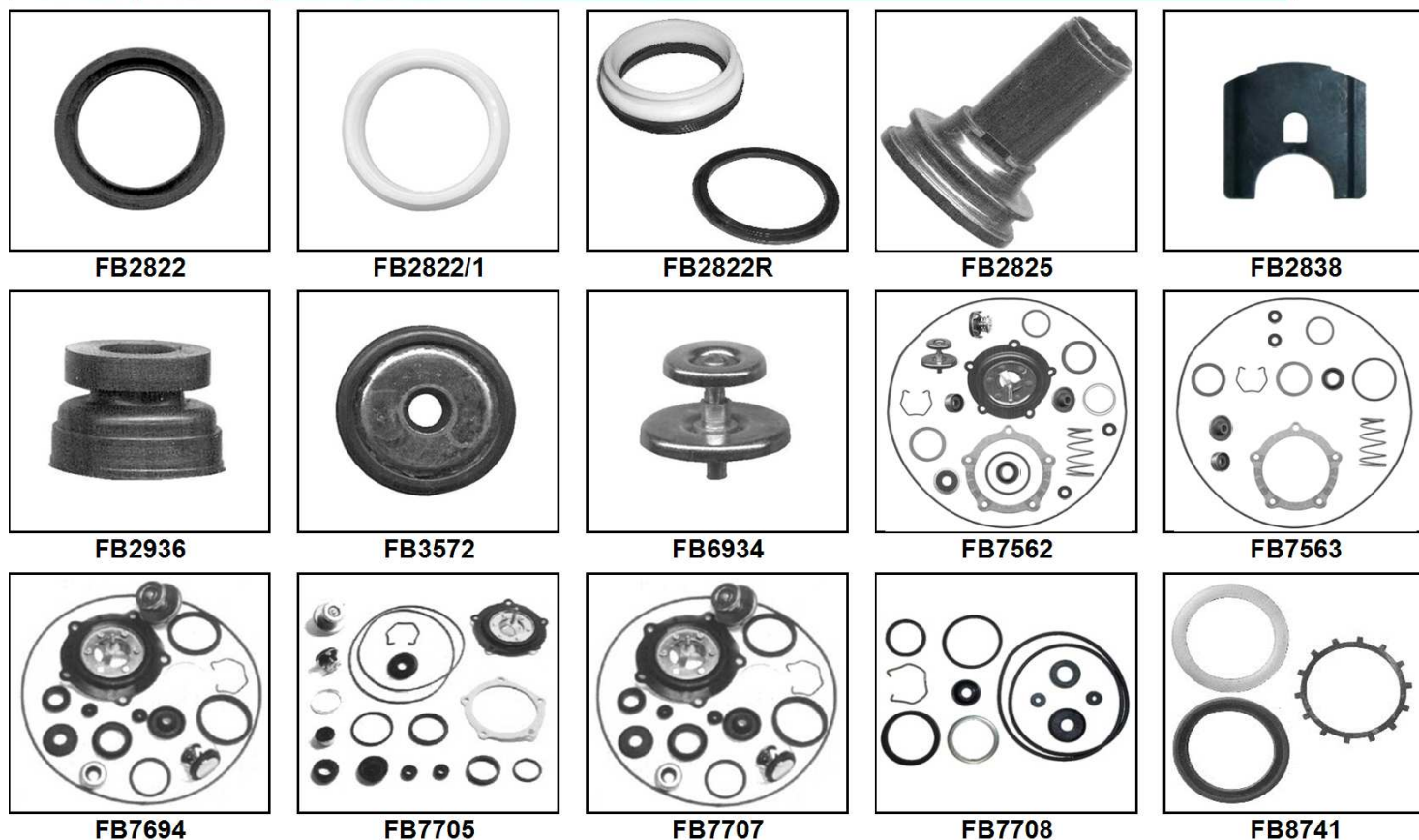

## DESPIECE Y REPARACIONES SERVO TENSA

Código	Descripción	Código	Descripción
FT0044	VASTAGO COMPLETO LARGO 0,70mm	FT1065	CUBETA 13/16"
FT0045	VASTAGO COMPLETO LARGO 0,85mm	FT1091	GUIA VASTAGO DE SALIDA ORIGINAL
FT0046	VASTAGO COMPLETO LARGO 100mm	FT1102	GUARDAPOLVO R9/11 DESCARTABLE
FT0047	VASTAGO COMPLETO LARGO 115mm	FT1103	FUELLE INT. SERVO R9/11 DESCART.
FT0048	VASTAGO SERVO R9/11	FT1104	ORING SERVO R9/11 DESCARTABLE
FT0066	SEGURO SEEGER.	FT1105	SELLO SERVO R9/11 DESCARTABLE
FT1002	ORING 21501002	FT1106	CHAPA P/SELLO T1105 SERVO R9/11 DESC.
FT1003	DIAFRAGMA	FT1186	RESORTE SERVO R9/11 DESCARTABLE
FT1008	ARANDELA DE CIERRE	FT1187	RESORTE SERVO R9/11 DESCARTABLE
FT1009	FILTRO DE SERVO HIDRAULICO	FT1189	VALVULA CONTROL R9/11 REFORMA
FT1014	TRABA DE SERVO	FT1190	REMACHE VALVULA R9/11 DESCART.
FT1016	CUBETA SERVO HIDRAULICO 1/2"	FT1719	CUBETA 13/16"
FT1018	CUBETA INFERIOR SERVO HIDRAULICO	FT1724	SELLO SERVO MECANICO
FT1022	EMPAQUETADORA DE UNION	FT1734	ORING 21501734
FT1027	VALVULA DE RETENCION	FT1736	ARANDELA TRABA
FT1028	ASIENTO DE VALVULA DE RETENCION	FT1737	RETEN RESORTE INFERIOR
FT1041	JUNTA DE SERVO	FT1738	RESORTE DE VALVULA DE CONTROL
FT1043	ORING 21501043	FT1742	ORING 21501742
FT1044	CUBETA SERVO HIDRAULICO 5/8"	FT1743	ARANDELA DE APOYO EN FIBRA
FT1048	VALVULA SERVO HIDRAULICO	FT1746	ARANDELA PROTEC. FUELLE EN FIBRA
FT1050	SEGURO DE SERVO	FT1747	ABRAZADERA DE FUELLE
FT1051	CUBETA 1"	FT1748	FUELLE INTER. SERVO SIMPLE/TANDEM



# DESPIECE Y REPARACIONES SERVO TENSA

# F

Código	Descripción	Código	Descripción
FT1750	ANILLO REFUERZO FUELLE T 1748	FT5580	RESORTE PARA VALVULA DE CONTROL
FT1779	GUARDAP. TRAS. SERVO MECANICO	FT6433	ORING VASTAGO MARK VI
FT1782	TRABA PLASTICA BAJA	FT6439	ORING SELLO MARK VI
FT1783	FILTRO SERVO MECANICO	FT6511	GUIA VASTAGO MARK VI ORIGINAL
FT1864	SELLO P/VALVULAS T9629-9484-9808	FT6511/1	BUJE PAST. P/SERVO TRAFIC
FT1864/1	SELLO PARA VÁLVULA R9/11	FT6579	SELLO VASTAGO MARK VI 3 PATAS
FT1900	RETEN GOMA DE SERVO P306 - ATE	FT6580	GUARDAPOLVO MARK VI
FT2064	ORING 21502064	FT6581	PISTON SERVO FORD TAUNUS
FT2065	ORING 21502065	FT6582	SEGURO DE PISTON T 6581 TAUNUS
FT2066	SELLO EXTERIOR SERVO TANDEM	FT6603	TOPE DE EMBOLO MARK VI
FT2068	BUJE DESLIZANTE MEDIANO ORIGINAL	FT6604	TOPE DE PALANCA MARK VI
FT2070	SELLO INTERIOR SERVO TANDEM	FT6640	FILTRO SERVO DESC. RENAULT 9/11
FT2091	ARANDELA SUPLEM. FUELLE T1748	FT6641	FILTRO MARK VI ORIGINAL
FT2358	INSERTO DE VALVULA	FT6643	BUJE GUIA MARK VI ORIGINAL
FT2527	TRABA PLASTICA ALTA	FT6643/1	BUJE GUIA GOLD MODELO NUEVO
FT2690	VASTAGO DE ACONDICIONAMIENTO	FT7437	VALVULA CONTROL TAUNUS
FT2707	CUERPO DE VALVULA SIMPLE/TANDEM	FT7438	SELLO DELANTERO R18 / P505 / F100
FT3000	ABRAZADERA P/MANGUERA DE 3/8"	FT7781	CODO DE MANGUERA FORD SIERRA
FT3001	ABRAZADERA P/MANGUERA DE 1/2"	FT8002	REP. SERVO MECANICO SIMPLE
FT3227	CONO SERVO CHICO	FT8003	REPARACION SERVO HIDRAULICO
FT3247	CONO SERVO GRANDE	FT8007	REPARACION SERVO MECANICO TANDEM
FT3405	FILTRO SERVO	FT8016	REPARACION SERVO MECANICO FIAT
FT3433	BUJE DESLIZANTE TANDEM	FT8029	REP. SERVO P505 / R18 / F100 MARK VI
FT3756	FILTRO SERVO MECANICO	FT8034	REP. SERVO RENAULT TRAFIC 2000
FT3798	BUJE DESLIZANTE LARGO ORIGINAL	FT9629/1	VALV. RET. ORIGINAL PARA PICO CURVO
FT4791	FILTRO SERVO MARK VI	FT9462	VALVULA DE CONTROL SERVO
FT4792	ORING SERVO MARK VI	FT9462/1	VALVULA DE CONTROL (TELEFONO)
FT4844	RETEN RESORTE INFERIOR	FT9484	VALVULA DE RETENCION PICO CURVO
FT4848	BUJE DESLIZANTE CORTO ORIGINAL	FT9629	VALVULA RETENCION PICO CURVO FINO
FT4849	BUJE DESLIZANTE LARGO ORIGINAL	FT9808	VALVULA DE RETENCION PICO RECTO
FT5304	ARANDELA REFUERZO FUELLE (NYLON)	FT9915	PALANCA DE RETENCION (ESTRELLA)



FT0044



FT0045



FT0046



FT0047



FT0048

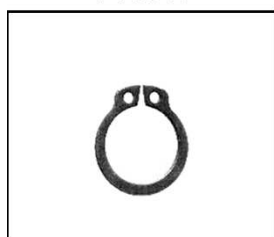

FT0066



FT1002

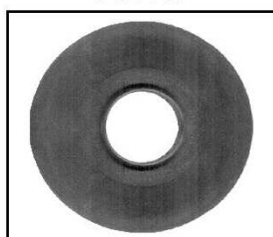

FT1003

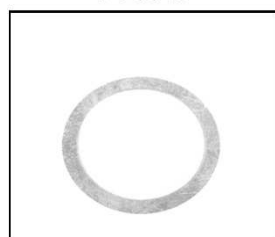

FT1008

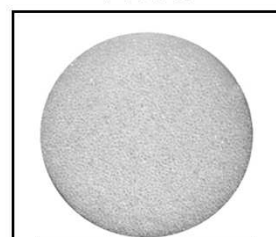

FT1009





BUSCAR

# DESPIECE Y REPARACIONES SERVO TENSA

# F



FT1014

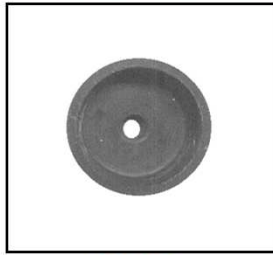

FT1016

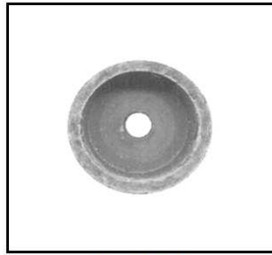

FT1018



FT1022



FT1027

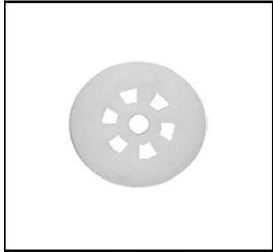

FT1028

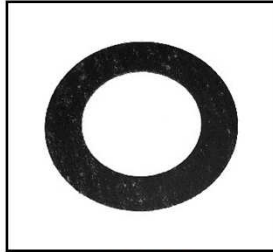

FT1041



FT1043



FT1044



FT1048

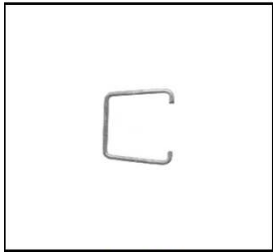

FT1050



FT1051



FT1065



FT1091

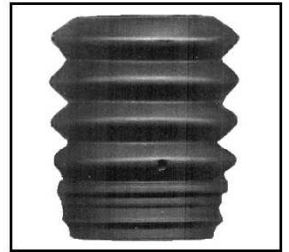

FT1102



FT1103



FT1104



FT1105

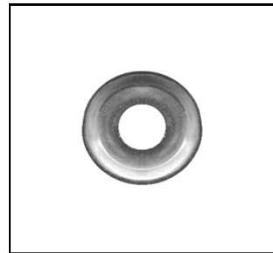

FT1106

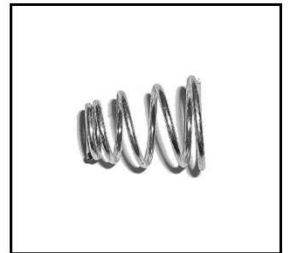

FT1186

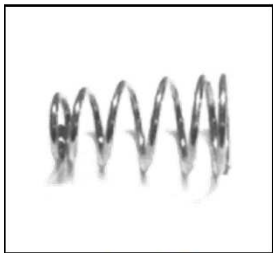

FT1187



FT1189

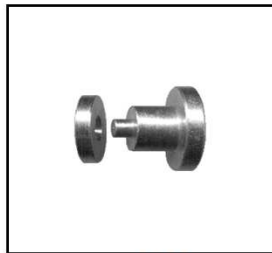

FT1190



FT1719

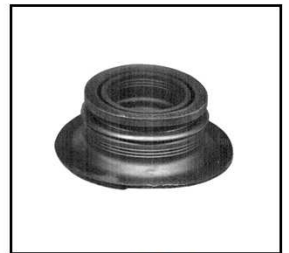

FT1724

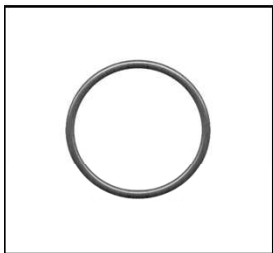

FT1734



FT1736



FT1737

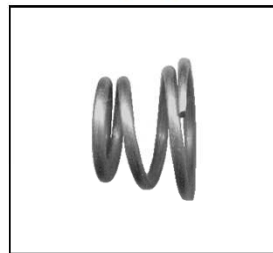

FT1738

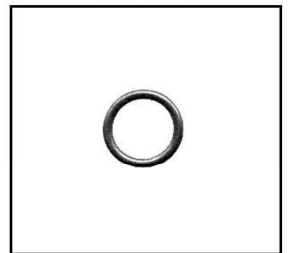

FT1742



BUSCAR

# DESPIECE Y REPARACIONES SERVO TENSA

# F

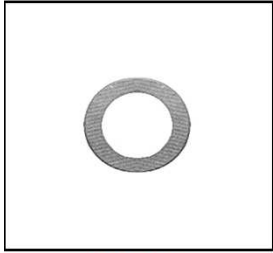

FT1743

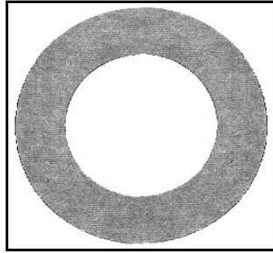

FT1746

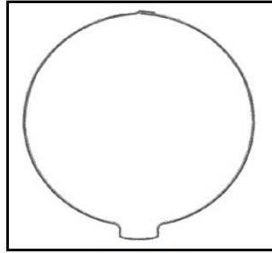

FT1747

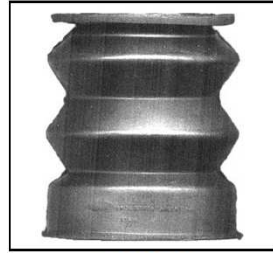

FT1748



FT1750



FT1779

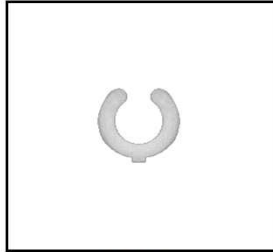

FT1782



FT1783



FT1864



FT1864/1



FT1900

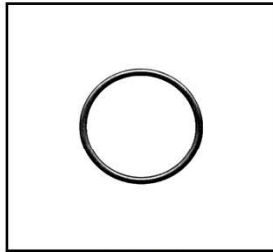

FT2064

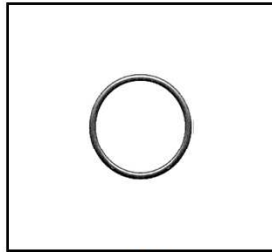

FT2065



FT2066

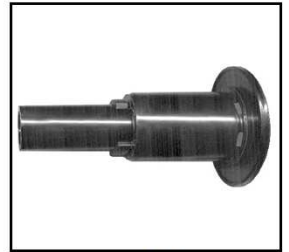

FT2068



FT2070



FT2091

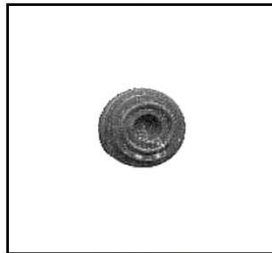

FT2358

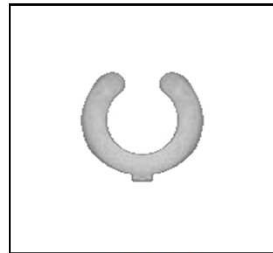

FT2527



FT2690

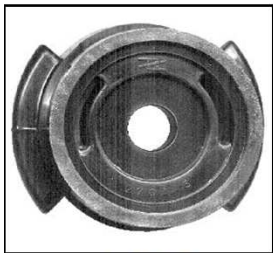

FT2707

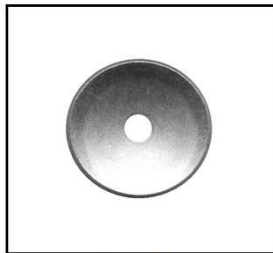

FT3227

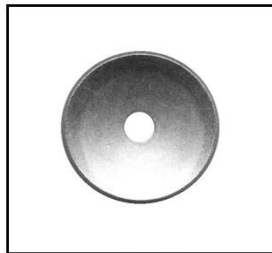

FT3247

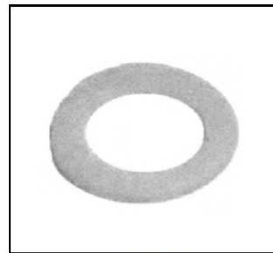

FT3405



FT3433

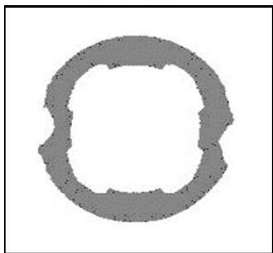

FT3756



FT3798

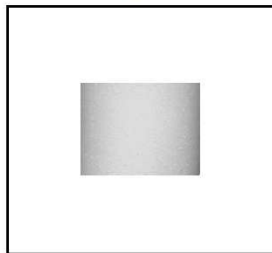

FT4791



FT4792



FT4844



BUSCAR

# DESPIECE Y REPARACIONES SERVO TENSA

# F



FT4848



FT4849



FT5304



FT5580



FT6433



FT6439



FT6511



FT6511/1



FT6579



FT6580

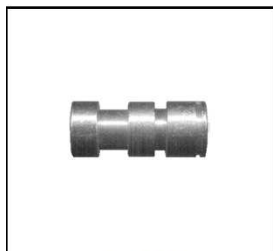

FT6581



FT6582



FT6603



FT6604

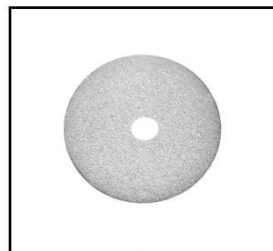

FT6640



FT6641



FT6643



FT6643/1



FT7437



FT7438



FT7781



FT8002



FT8003



FT8007



FT8016



FT8029



FT8034



FT9462



FT9462/1



FT9484



# DESPIECE Y REPARACIONES SERVO TENSA

# F



FT9629



FT9629/1



FT9808



FT9915

## DESPIECE Y REPARACIONES SERVO MIDLAND

Código	Descripción	Código	Descripción
FM1719	CUBETA SERVO 7/8"	FM7531	JUEGO DE REPARACION FORD F600
FM1930	CUBETA SERVO 3/4"	FM7539	JGO. REP. CAMIONES FORD - BEDFORD



FM1719

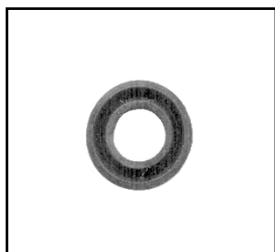

FM1930

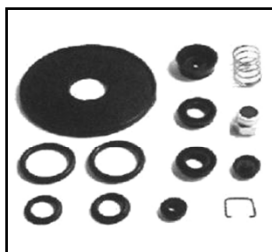

FM7531

## DESPIECE Y REPARACIONES SERVO SYLVANIA

Código	Descripción	Código	Descripción
FS0048	VALVULA DE RETENCION	FS10049/1	EMPUJE CORTO
FS0048/1	VALV. RETENCION P/MANGUERA 1/2"	FS10099	JGO. REP. MENOR SERVO SYLVANIA
FS10004	DIAFRAGMA	FS10199	JGO. REP. MAYOR CON DIAF. 10031
FS10011	VALVULA SERVO SYLVANIA	FS10299	JGO. REP. MAYOR CON DIAF. 10032
FS10026	ANILLO	FS18751	CUBETA
FS10049	EMPUJE LARGO	FS50015	DIAFRAGMA SERVO DIAMETRO 75 mm



FS0048



FS0048/1



FS10004

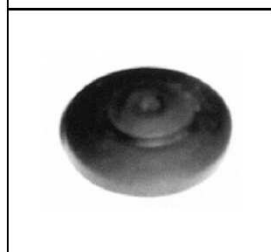

FS10011



FS10026



FS10049



FS10049/1



FS10099

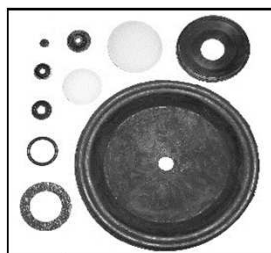

FS10199



FS10299



FS50015

## DESPIECE Y REPARACIONES SERVO M. BENZ

Código	Descripción	Código	Descripción
FMB029	ORING SERVO M. BENZ 608	FMB0740	PERNO PARA ANCLA SERVO M. BENZ
FMB0255	RETEN GRANDE SERVO M. BENZ 608	FMB1331	GUARDAPOLVO SERVO MB 1114
FMB0256	RETEN CHICO SERVO M. BENZ 608	FMB4130	REP. SERVO M. BENZ 1114 (REFORMA)
FMB0259	RETEN MEDIANO SERVO M. BENZ 608	FMB5158	VALV. TROMPITO SERVO M. BENZ 1114
FMB0260	RETEN VALV. SERVO M. BENZ 608	FMB5159	RETEN CONICO SERVO M. BENZ 1114
FMB0265	RETEN PARA REPARACION (MB-4130)	FMB5160	RETEN GRANDE SERVO M. BENZ 1114
FMB0608	JGO. REP. SERVO M. BENZ 608	FMB5160/1	RETEN GDE. SUPERMEDIDA MB 1114
FMB0612	PERNO PASADOR ANCLA SERVO MB	FMB5162	RETEN RECTO CHICO SERVO MB 1114
FMB0613	ANCLA DE SERVO M. BENZ	FMB5163	REPARACION SERVO M. BENZ 1114
FMB0669	PLACA ACCIONAMIENTO SERVO M. BENZ	FMB5163/1	REP. SERVO MB1114 (SUPERMEDIDA)

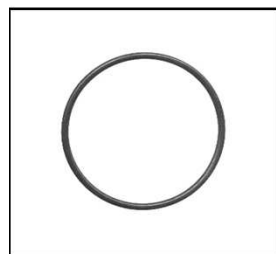
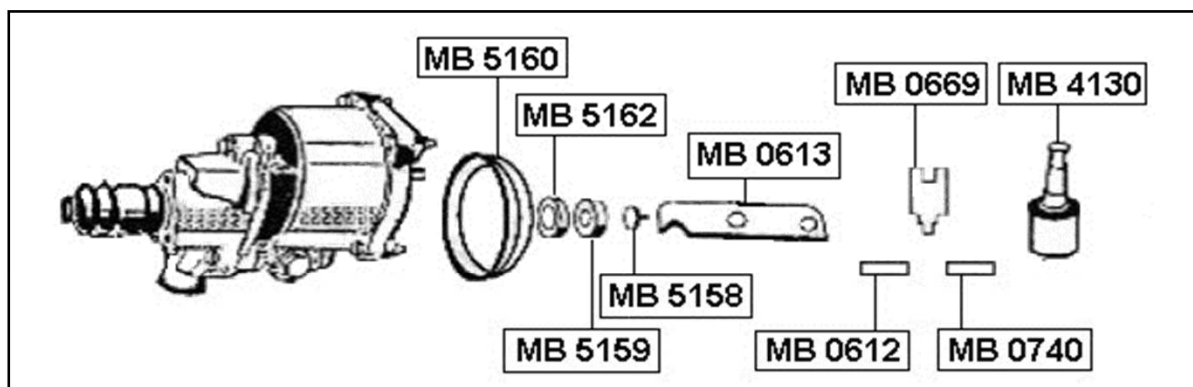

FMB029



FMB0255



FMB0256



FMB0259



FMB0260



FMB0265



FMB0608



FMB0612



FMB0613



FMB0669



BUSCAR



FMB0740



FMB4130



FMB5158



FMB5159

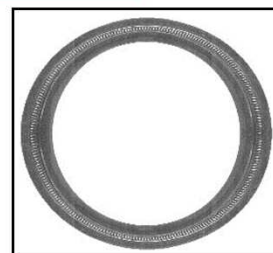

FMB5160



FMB5160/1



FMB5162

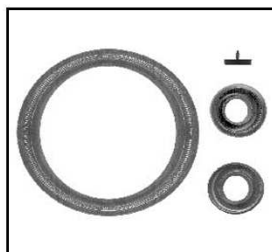

FMB5163

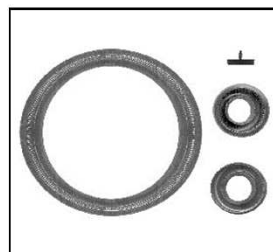

FMB5163/1

## MANGUERAS PARA SERVO

Código	Descripción	Código	Descripción
FMG30677	MANGUERA PARA SERVO 3/8"	FMG30678	MANGUERA PARA SERVO 1/2"
FMG30815	MANGUERA PARA SERVO 3/4"		



## VARIOS

Código	Descripción	Código	Descripción
F1000	SOPORTE P/VALV. CTROL. (COPITA) CHICO	F1002	SOPORTE P/VALV. CTROL (COPITA) GRANDE
F1001	SOPORTE P/VALV. CTROL (COPITA) MEDIANO		

